

RH004

RH004 can be installed in as little as 20 minutes. Designed with our unique 3-three step installation system, RH004 breaks the arduous task of installing the entire range hood into 3 easy steps. We've even added an installation template to help you align your ceiling marks without the guesswork. One look at the classic European design and gentle clear-glass curved canopy will have you sold. Love at first sight? Yes. It's possible.

FEATURES OF HIGH QUALITY

- Available in 36"
- Available with 600-cfm internally installed motor
- Stainless steel 3-speed mechanical controls
- Sturdy stainless steel construction
- Durable, washable 5-ply aluminum mesh filters
- Optional recirculation kit
- Standard telescopic duct covers up to 9' ceilings
- Optional duct cover extensions for up to 12' ceilings
- Designed for 6-inch vertical ducted installations



RH004

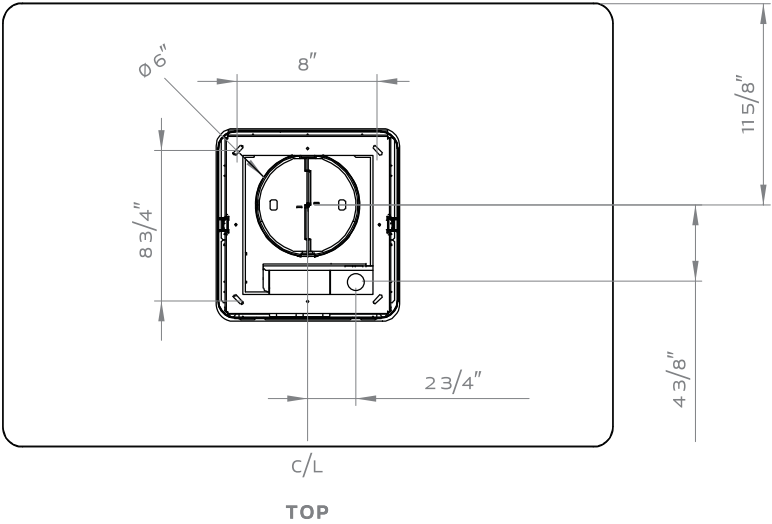
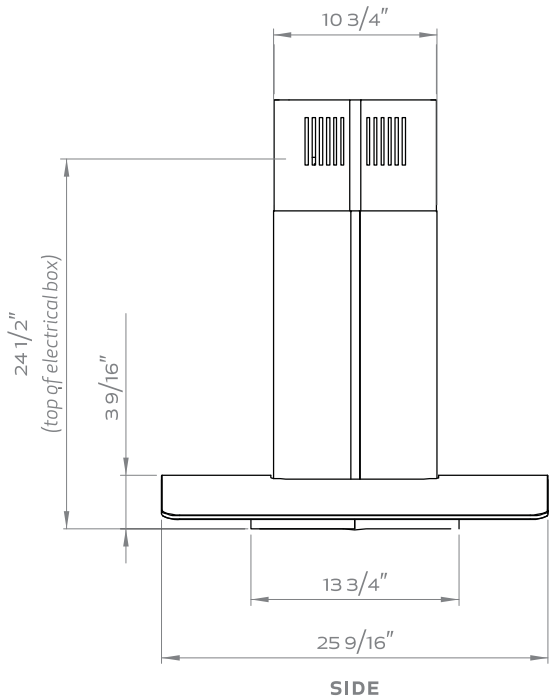
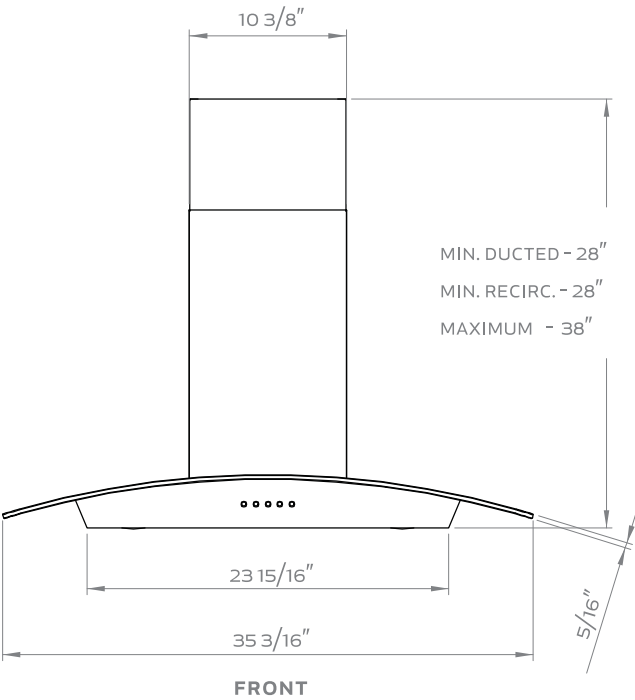

STANDARD
DUCT COVER

EXTENSION
DUCT COVER

CEILING HEIGHT	8'	8.5'	9'	9.5'	10'	10.5'	11'	12'
Ducted Mounting Height*	26"-32"	28"-34"	34"-34"	N/A	N/A	N/A	N/A	N/A
Recirc. Mounting Height*	26"-32"	28"-34"	34"-34"	N/A	N/A	N/A	N/A	N/A
Ducted Mounting Height*	N/A	N/A	N/A	26"-30"	26"-34"	26"-34"	26"-34"	30"-34"
Recirc. Mounting Height*	N/A	N/A	N/A	26"-30"	26"-34"	26"-34"	26"-34"	30"-34"

*Mounting height refers to distance between top of a 36" tall cooking surface and bottom of hood.

RH00436S, G	
SIZE	36"
NET WIDTH	35-3/16"
PERFORMANCE	
Blower CFM, Max.	600
Sones, Max.	6
COLOR	
Stainless Steel	SS / SS + Glass
FEATURES	
Controls	Mechanical Push Button
Speed Levels	3
Delay Off	No
Lighting	Halogen, 50W x2
Dual Level Lighting	No
Filters	Stainless Steel Mesh
Recirculating Option	Yes
Extension Duct Cover Option	Yes, Up to 12' Ceiling
DUCT SPECIFICATIONS	
Internal Blower - Vertical	6" round
Internal Blower - Horizontal	NA
AC INPUT	
120V - 60Hz	
AC POWER	
400W, 3 .5A	
OPTIONAL ACCESSORIES	
Recirculating Kit	RHRK004S
Extension Duct Cover	RHEX004S
MOUNTING HEIGHT*	
26" - 34"	